

ISE Foundation

Sample Independent listening task 1 — Train Station

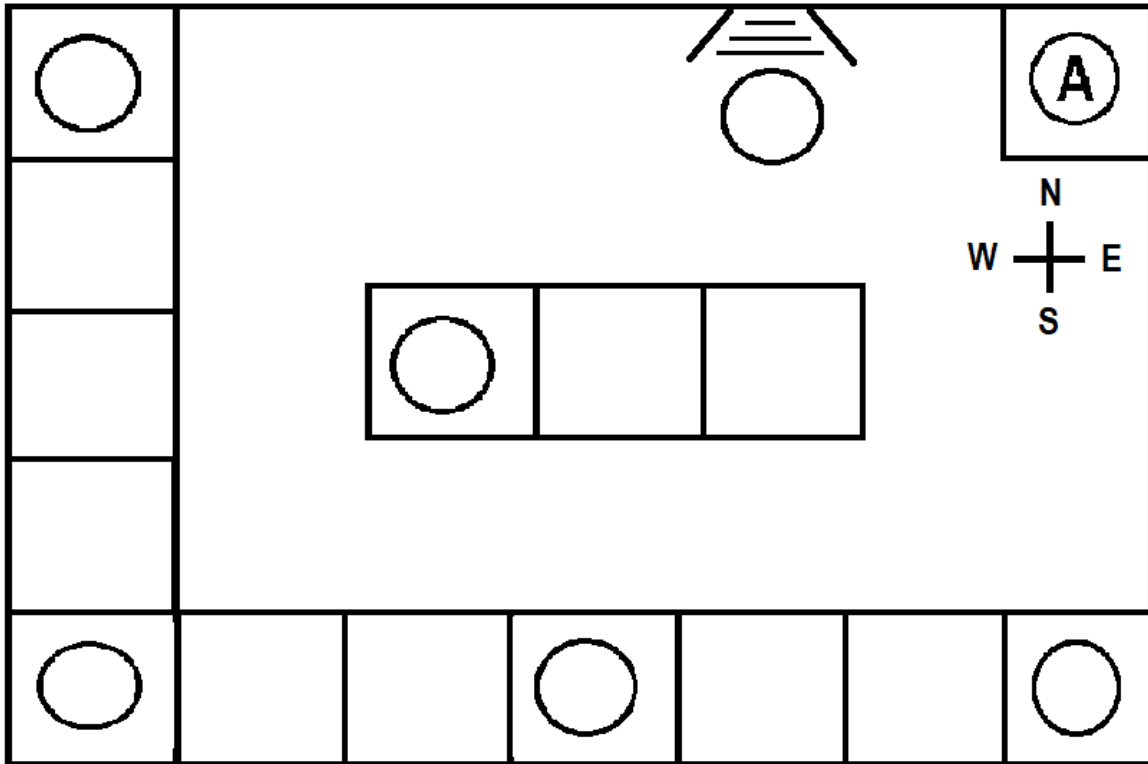
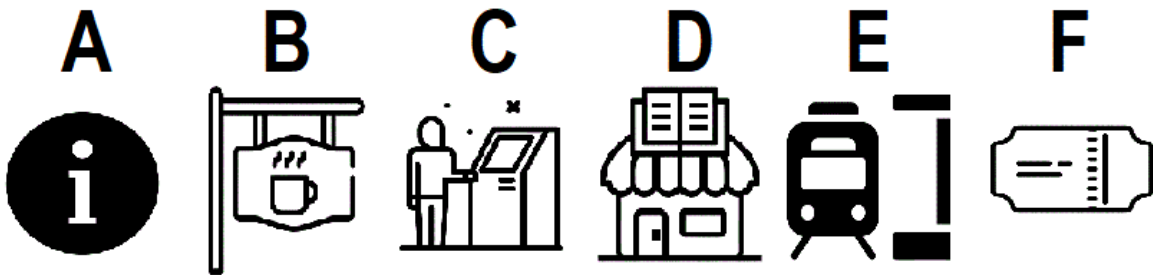

- A** **B** **C** **D** **E** **F**
- 
- The icons are: A: Information sign (circle with 'i'); B: Cafe (cup with steam); C: Ticket office (person at counter); D: Shop (storefront); E: Train; F: Ticket.

Write the correct letters in the circles. There is an example to show you what to do.